



ROMETAL Soluções & Alumínio

Cód.: 1394 | Rev.:01

MANUAL DE MONTAGEM
MANUAL DE INSTALACIÓN

RO 70



Portas de até
Puertas hasta
60kg



Portas de
Puertas de
10mm

COMPONENTES DO KIT PARA 01 PORTA
COMPONENTES DEL KIT PARA 01 PUERTA

- 02 Carros deslizadores - 02 Molas Estacionárias
- 02 Guias Superiores - 02 Limitadores inferiores
- 02 Carros corredizos - 02 Resortes
- 02 Guias Superiores - 02 Limitadores inferiores

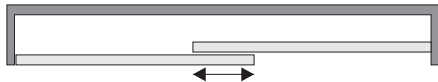
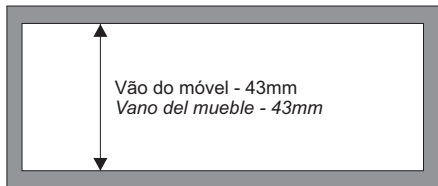

O transpasse indicado entre portas é de 35mm
El traspaso indicado entre puertas es de 35mm



MONTADOR, SIGA ESTAS INSTRUÇÕES COM ATENÇÃO.
INSTALADOR, SIGA LAS INSTRUCCIONES CON ATENCIÓN.

1

Instale os trilhos/*Instale los rieles*

Superior
RM-035

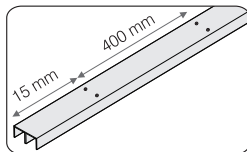

Inferior
RM-034

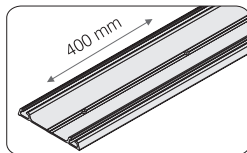

Fazer a furação no centro do trilho
Hacer la perforación en el centro del riel

2

Instale a mola estacionária e depois o limitador
Instale el resorte y después el limitador

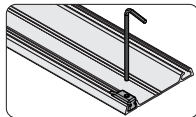
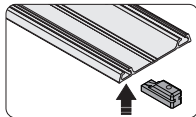
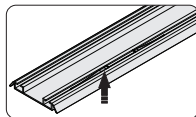
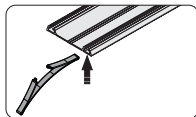

3 Instalar os guias e carros
Instale los guías y carros

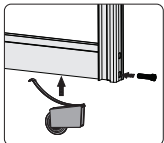
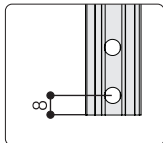
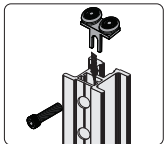
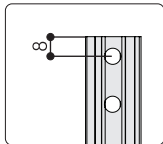

4 Montar as portas/*Montaje de las puertas*

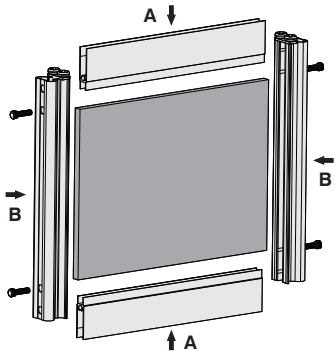

5 Encaixar as portas/*Encaje las puertas*

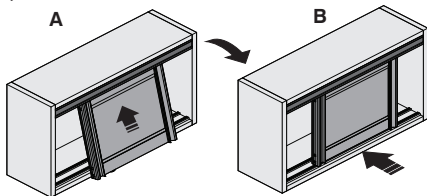

6 Sistema de regulagem de altura da porta
Sistema de regulación de altura de la puerta

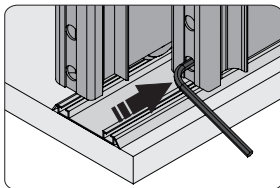

Regular a altura da porta no deslizador inferior.
Regular la altura de la puerta en el deslizador inferior.



ROMETAL

Rodovia BR 470 | Km 174,5 | Nº 4075
Bairro Universal | CEP 95330-000
Veranópolis | RS | Brasil
Fone +55 54 3441 3100
atendimento@rometal.com.br

www.rometal.com.br