

RO-23

1 PORTA
1 DOOR
1 PUERTA
1 PORTE

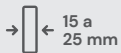

COMPONENTES/ COMPONENTS/ COMPONENTES/ COMPOSANTS

Inclusos no Kit/ Included in the Kit/ Incluidos en el Kit/ Inclus dans le Kit

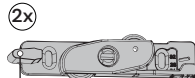
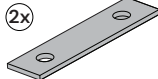
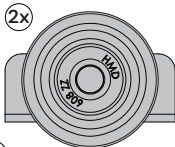

Conforme aplicação/ As per application
Según la aplicación/ Selon l'application

Recomendados/ Recommended/ Recomendados/ Reconnandés



3,5 x 16 CC
Carros inferiores
Bottom carriages
Carros inferiores
Chariots inférieurs

3,5 x 22 CC
Guias e freios
Guides and brakes
Guias y frenos
Guides et freins

Opcionais/ Optional/ Opcionales/ Optionnels

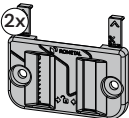

Dispositivo antidescarrilamento
Anti-derailment device
Dispositivo antidescarrilamento
Dispositif anti-déraillement

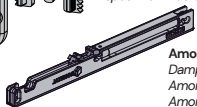

Amortecedor Comfort 240
Damper Comfort 240
Amortiguador Comfort 240
Amortisseur Comfort 240

CÁLCULO DA PORTA/ DOOR CALCULATION
CÁLCULO DE LA PUERTA/ CALCUL DE LA PORTE

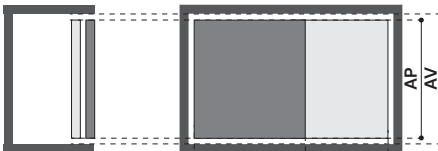

AP= AV-32 mm

Altura da porta (AP)
Door height
Altura de la puerta
Hauteur de la porte

Altura do vão (AV)
Opening height
Altura del vano
Hauteur de l'ouverture



20 a 30 mm

Transpasse indicado
Recommended overlap
Solape recomendado
Recouvrement recommandé

INSTALAÇÃO/ INSTALLATION/ INSTALACIÓN/ INSTALLATION

1 Furações/ Drillings/ Perforaciones/ Perçages

MDF/Alumínio/ Aluminum / Aluminio / Aluminium

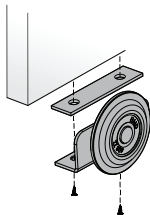
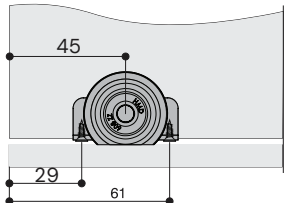

Utilize a chapa inferior para regular a altura da porta
Use the lower plate to adjust the door height
Utilice la placa inferior para regular la altura de la puerta
Utilisez la plaque inférieure pour régler la hauteur de la porte

2 Instale os guias/ Install guides
Instale las guías/ Installez les guides

Guia Flex/ Flex Guide / Guía Flex / Guide Flex

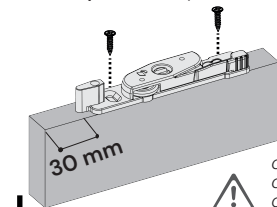

Centralize o guia na porta
Center the guide on the door
Centre la guía en la puerta
Centrez le guide sur la porte

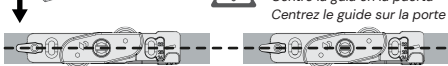

Espaçamento do trilho/ Track spacing
Espaciado del riel/ Espacement du rail

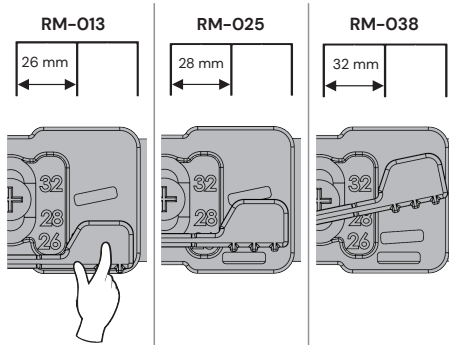

3 Fixe o antidescarrilamento
Fix the anti-derailment device
Fije el dispositivo de antidescarrilamiento
Fixez le dispositif anti-déraillement



Opções de guias
Guide options
Opciones de guías
Options de guides



Amortecedor Comfort 240
Damper Comfort 240
Amortiguador Comfort 240
Amortisseur Comfort 240

Com guia
With guide
Con guía
Avec guide



3,5 x 12 CF
Parafusos inclusos no kit
Tornillos incluidos en el kit
Vis incluses dans le kit

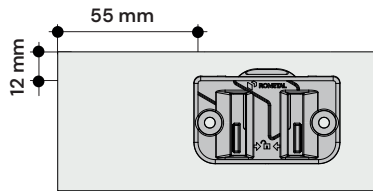

4 Destaque os posicionadores

Remove the positioners
Retire los posicionadores
Retirez les positionneurs

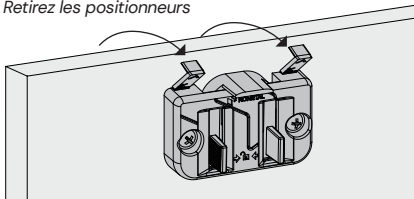

5 Instale os trilhos/ Install the tracks

Fije los rieles/ Installez les rails

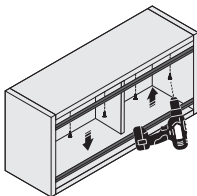
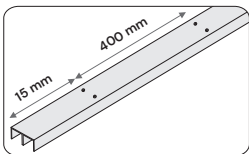

6 Fixe o freio no trilho superior

Fix the brake to the top track
Fije el freno en el riel superior
Fixez le frein sur le rail supérieur

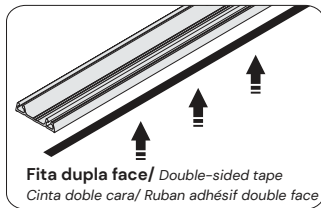
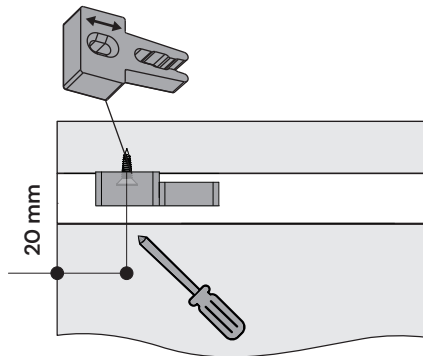

Fita dupla face/ Double-sided tape
Cinta doble cara/ Ruban adhésif double face

7 Encaixe as portas/ Fit the doors
Encaje las puertas / Insérez les portes

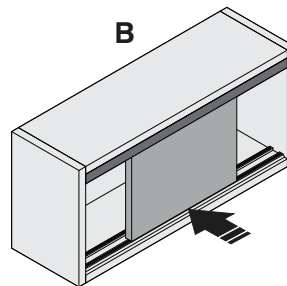
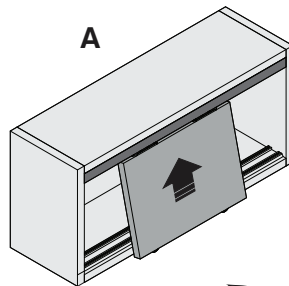

9 Regule o antidescarrilamento
Adjust the anti-derailment device
Ajuste el dispositivo antidescarrilamento
Réglez le dispositif anti-déraillement

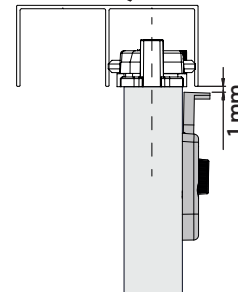
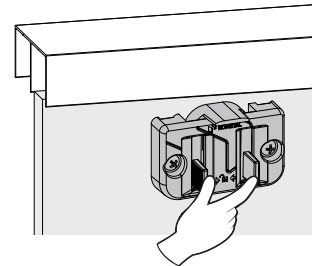

Unidade Sistemas
Rodovia BR 470, Km 174,5, nº 4075
Bairro Universal | Veranópolis
RS | Brasil | CEP 95330-000

Unidade Alumínio
Estrada Velha da Vacaria, nº 1339
Bairro Sapopema | Veranópolis
RS | Brasil | CEP 95330-000

www.rometal.com.br